

Item No. \_\_\_\_\_

Quantity \_\_\_\_\_



## BEVERAGE-AIR

### Commercial Refrigeration Equipment General Specifications

Whenever space is a limiting factor and health inspection approval is critical, compact, shallow-depth refrigerators and freezers have provided the answer. Single door refrigerator and matching freezer are only 20" wide by 21" deep. Overall, height on 6" legs supplied is 31". Two-door companion refrigerator is 34" wide by 23" deep.

Models feature construction with stainless steel exteriors and anodized aluminum interiors. Doors are mounted on gravity self-closing hinges with 120° stay open position. Magnetic door gaskets are used to accomplish positive door sealing. Two epoxy coated wire shelves are provided behind each door.

UCR27SD, shallow depth refrigerator model is the choice of many manufacturers of specialty carts and kiosks. It is constructed along the same specs as the compact models but is larger in depth (27") and width (27") and height (34-1/2") on 6" legs.

All of the shallow depth models feature front breathing under doors to accommodate location in confined areas. Balanced refrigeration systems provide refrigerator-holding temperatures in the 35° to 38° range. Freezer model temperature is held below zero. Freezer model includes automatic electric defrosting. Refrigerants used are R134a in the refrigerators and 404A in the freezer. Both are CFC free providing full compliance with environmental concerns.

Cabinet insulation is foamed-in-place polyurethane for maximum energy conservation and structural integrity. It also is CFC free in providing compliance with environmental concerns.

### SHALLOW DEPTH UNDERCOUNTER REFRIGERATORS AND FREEZER FOOD PREPARATION SERIES

MODELS:  
UCR20  
UCF20  
UCR34  
UCR27SD



UCR / UCF20



UCR34



UCR27SD



Made in USA

<http://www.Beverage-Air.com>

<http://CCR.Carrier.com>



BEVERAGE-AIR

P.O. Box 5932, Spartanburg, S.C. 29304-5932  
1-800-845-9800 FAX# 864-582-5083

Model Specified \_\_\_\_\_ Store# \_\_\_\_\_

Location \_\_\_\_\_ Quantity \_\_\_\_\_



**BEVERAGE-AIR**

## Shallow Depth Undercounter Refrigerators/Freezers

Models: UCR20 / UCF20 / UCR34 / UCR27SD

| MODEL                             | UCR20       | UCF20       | UCR34       | UCR27SD                          |
|-----------------------------------|-------------|-------------|-------------|----------------------------------|
| <b>DIMENSIONAL DATA</b>           |             |             |             |                                  |
| Net Capacity (cubic ft.)          | 2.7         | 2.7         | 5.5         | 6.2                              |
| Net Capacity (liters)             | 76          | 76          | 156         | 175                              |
| Length overall (inches)           | 20"         | 20"         | 34"         | 27"                              |
| Length overall (mm)               | 508         | 508         | 864         | 685                              |
| Depth overall - Less handle       | 21"         | 21"         | 21"         | 27 <sup>3</sup> / <sub>4</sub> " |
| Depth overall (mm) - Less handle  | 584         | 584         | 584         | 685                              |
| Height overall - on 6" legs       | 31"         | 31"         | 31"         | 34 <sup>1</sup> / <sub>2</sub> " |
| Height overall - on 6" legs (mm)  | 787         | 787         | 787         | 622                              |
| Depth with door open 90° (inches) | 39 1/2"     | 39 1/2"     | 37 1/4"     | 51 3/8"                          |
| Clear Door Opening (inches)       | 16 x 18 1/2 | 16 x 18 1/2 | 16 x 18 1/2 | 22 1/2 x 21 1/2                  |
| Number of shelves                 | 2           | 2           | 4           | 2                                |
| Number of doors                   | 1           | 1           | 2           | 1                                |
| <b>ELECTRICAL DATA</b>            |             |             |             |                                  |
| Full load amperes 115/60/1        | 3.5         | 6.5         | 4.0         | 4.0                              |
| Full load amperes 220/50/1        | -           | -           | -           | -                                |
| <b>REFRIGERATION DATA</b>         |             |             |             |                                  |
| Refrigerant                       | R134a       | 404A        | R134a       | R134a                            |
| Horsepower                        | 1/6         | 1/4         | 1/5         | 1/6                              |
| <b>WEIGHT DATA</b>                |             |             |             |                                  |
| Gross Weight (Crated lbs)         | 111         | 119         | 158         | 157                              |
| Gross Weight (Crated kg)          | 50          | 54          | 72          | 71                               |

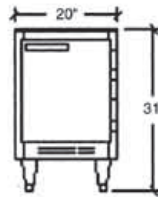

UCR/UCF-20 Front

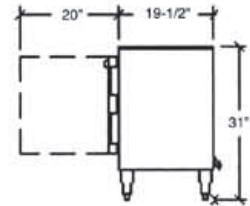

UCR/UCF-20 End

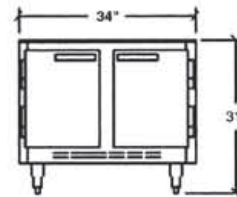

UCR-34 Front

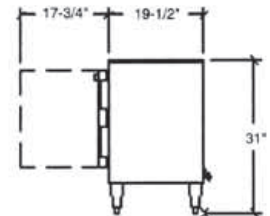

UCR-34 End

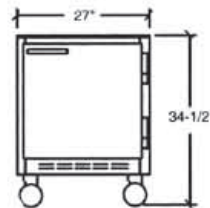

UCR-27SD Front

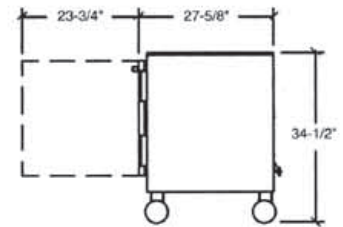

UCR-27SD End



Available From:



**BEVERAGE-AIR**

PO Box 5932 • Spartanburg, SC • 29304 • USA  
 1-800-845-9800 • Fax No. 1-864-582-5083  
[www.Beverage-Air.com](http://www.Beverage-Air.com)